

D

C

B

A

OPENING DETAIL TO MAKE, TO FIT BAFFLE FLAP (#100-050-002)

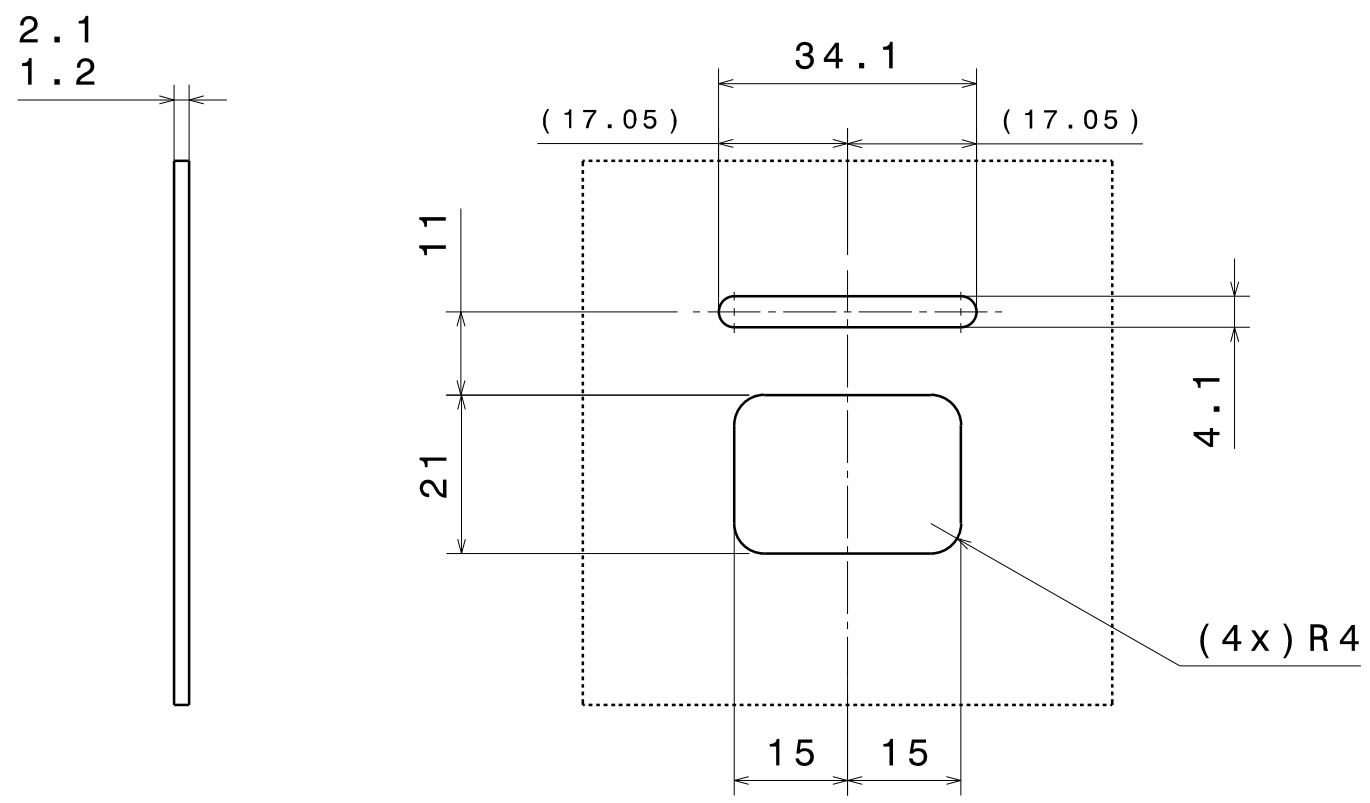

WARM FLAP AT 80°C FOR 1 HOUR PRIOR TO FITMENT

REVISIONS

ISSUE:	DESCRIPTION:	DATE:	BY:
00	ORIGINAL DESIGN	13/04/2017	MP
01			
02			
03			
04			
05			
06			
07			
08			
09			
10			

DESCRIPTION:

OPENING DETAIL FOR BAFFLE FLAP



DRAWING NUMBER: 100-050-009.00

ISSUE: 1/1

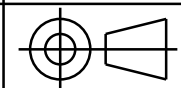

DIMENSIONS IN: mm

MATERIAL : ---  
TREATMENT : ---  
FINISH : ---  
PACKAGING : ---

SCALE: 1:1 @ A4

TOLERANCES & FINISH (UNLESS STATED):  
Linear : ±0.2 mm  
Angular : ±0.15°  
Roughness : Ra 3.2  
Threads : 6H / 6g  
Deburring : Chamfer 0.2 to 0.4 mm  
Geometric tolerances : MMC

DESIGNED BY: M. PETITJEAN  
CHECKED BY: S. RUBIO

SIGN OFF:   
13/04/2017  
S. RUBIO

THIS DRAWING SHALL NOT BE LENT, COPIED OR DISCLOSED TO ANY OTHER PERSON OR USED FOR ANY PURPOSE WITHOUT THE WRITTEN CONSENT OF SWINDON POWERTRAIN LTD

D

C

B

A

4

3

2

1

4

3

2

1